

MonnitLink Wireless Cellular Gateways

General Description

Don't have an existing network connection where you need it most? The MonnitLink™ Cellular gateway will allow your Monnit Wireless Sensors to communicate with the iMonnit™ Online Wireless Sensor Monitoring and Notification System via cellular transmission. This is the perfect solution for remote locations, or where an existing internet connection is not an option.

The cellular gateways are advanced all wireless M2M gateways that enable fast time-to-market solutions for a wide range of M2M applications.

The MonnitLink Cellular Gateways are based on the latest Dual-band CDMA wireless engine and comes integrated with Monnit's wireless access point network (WAN) for use with all Monnit wireless sensors.

Monnit's cellular gateways respond to the increasing market need for global technology that accommodates a variety of vertical M2M application segments and remote wireless sensor management solutions.

HOW THE SYSTEM WORKS



Example Applications

- Remote Location Monitoring
- Shipping and Transportation
- Agricultural Monitoring
- Vacant Property Management
- Vacation Home Property Management
- Construction Site Monitoring
- Data Center Monitoring
- Warehouse Monitoring
- Manufacturing and Production Monitoring
- Agricultural Monitoring

And many more...

Features

- True plug & play, no hassles for internet configuration set-up
- No PC required for operation
- Low-cost cellular service packages
- Remote software upgrade capability
- Local status LEDs with transmission and online status indicators
- 50,000 sensor message memory
- AC power supply
- Optional 24 hour battery backup in event of power outage
- 2G >> Dual Band CDMA (800/1900 MHz)
- 3G >> Tri-Band UMTS (GSM/GPRS, 850 / 1700 / 1900 MHz)
- Industrial >> Weather & Shock Proof





Data Sheets & Options

MonnitLink™ 2G CDMA Cellular Gateway	2
MonnitLink™ 3G Cellular Gateway (North America)	3
MonnitLink™ Industrial Cellular Gateway	4
MonnitLink™ International Cellular Gateway	5
Notes	6

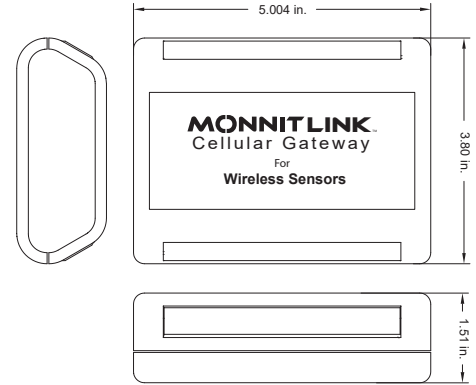
MonnitLink™ 2G CDMA Cellular Gateway



Technical Specifications		
Cellular Model	CGW2	CGW3
Carrier	Verizon Wireless	Sprint / U.S. Cellular
CDMA	Dual Band CDMA Frequency Range: 800 / 1900 MHz	
Antenna	Connector: RP-SMA Gain (dBi): 1.5	
Power		
Input Power	5.5 VDC @ 900 mA	
Optional Battery Backup	Battery Type: Rechargeable Lithium Polymer	
	Battery Duration: Up to 24 hours	
	Battery Cycle Life: 500 times	
Mechanical		
LEDs	Cellular Status LED, Online Status LED, Sensor Network Status LED	
Device Memory	50,000 sensor messages (Sensor messages will be stored in the event of Internet outage and transferred when connection is restored)	
Enclosure	ABS	
Dimensions	5.004 x 3.8 x 1.51 in.	
Weight	7 ounces	
Environmental		
Operating Temperature	-10 to +45°C (14 to 113°F)	
Storage Temperature	-20 to +60°C (-4 to 140°F)	
Certifications	FCC: ZTL- RFSC1 and FCC: MIVCNN0301 IC: 9794A-RFSC1 and IC: 4160a-CNN0301	
   Industry Canada		

MonnitLink™ 3G Cellular Gateway (North America)

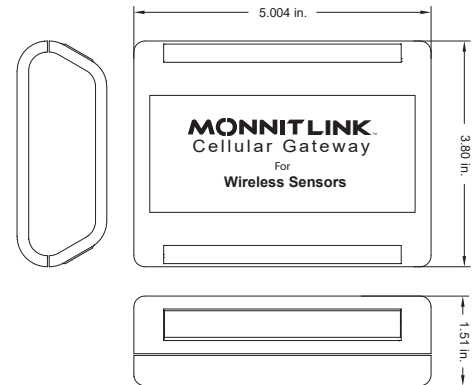

Technical Specifications

Cellular

Cellular Technology: 3G UMTS / GSM / GPRS fallback
 Frequency Range: 800/850, 900, 2100 MHz

Antenna: Connector: RP-SMA
 Gain (dBi): 1.5

SIM Card Compatibility: Mini-SIM (2FF) 25 mm x 15 mm x 0.76 mm

Power

Input Power: 5.5 VDC @ 2.5 A

Optional Battery Backup: Battery Type: Rechargeable Lithium Polymer

Battery Duration: Up to 24 hours

Battery Cycle Life: 500 times

Mechanical

LEDs: Cellular Status LED, Online Status LED, Sensor Network Status LED

Device Memory: 50,000 sensor messages
 (Sensor messages will be stored in the event of Internet outage and transferred when connection is restored)

Enclosure: ABS

Dimensions: 5.004 x 3.8 x 1.51 in.

Weight: 7 ounces

Environmental

Operating Temperature: -10 to +45°C (14 to 113°F)

Storage Temperature: -20 to +60°C (-4 to 140°F)

Certifications: 

MonnitLink™ Industrial Cellular Gateway

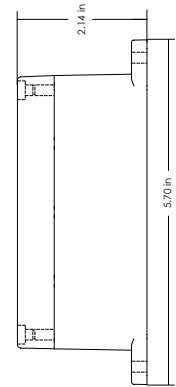
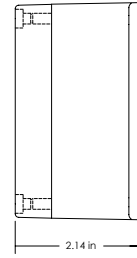
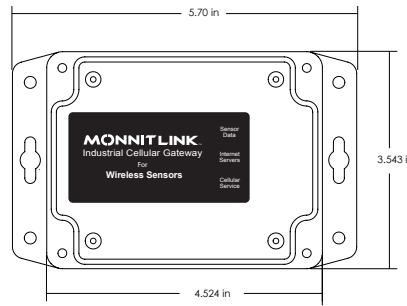

Technical Specifications

Cellular

Available Cellular Technologies	Dual Band CDMA (Frequency Range: 800 / 1900 MHz) 3G - UMTS (Frequency Range: 850 / 1700 / 1900 MHz) 2G - GSM / GPRS (Frequency Range: 850 / 900 / 1800 / 1900 MHz)
Antenna	Articulating Dipole, Connector: RP-SMA, Gain (dBi): 1.5
SIM Card Compatibility	Mini-SIM (2FF) 25 mm x 15 mm x 0.76 mm

Power

Power Supply	5.5 VDC @ 900 mA (rated for outdoor use)
Optional Battery Backup	Battery Type: Rechargeable Lithium Polymer
	Battery Duration: Up to 24 hours
	Battery Cycle Life: 500 times

Mechanical

LEDs	Cellular Status LED, Online Status LED, Sensor Network Status LED
Device Memory:	50,000 sensor messages (messages will be stored in the event of Internet outage and transferred when connection is restored).
Enclosure	NEMA 1, 2, 4, 4x, 12 and 13 rated, sealed and weather proof Monnit's NEMA rated enclosures are constructed for both indoor or outdoor use and protect the enclosed circuitry against the ingress of solid foreign objects like dust as well as the damaging effects of water (rain, sleet, snow, splashing water, and hose directed water).
Dimensions	5.70 x 3.543 x 2.14 in.
Weight	12 ounces

Environmental

Operating Temperature	-10 to +45°C (14 to 113°F)
Storage Temperature	-20 to +60°C (-4 to 140°F)

Certifications



CGW2 CDMA	FCC: ZTL- RFSC1, FCC: MIVCNN0301	IC: 9794A-RFSC1 and IC: 4160a-CNN0301
CGW3 CDMA	FCC: ZTL- RFSC1, FCC: RI7CE910-DUAL	IC: 9794A-RFSC1 and IC: 5131A-CE910DUAL
CGW3 3G	FCC: ZTL- RFSC1, FCC: RI7HE910NA	IC: 9794A-RFSC1 and IC: 5131A-HE910NA
CGW3 2G	FCC: ZTL- RFSC1, FCC: RI7GE910	IC: 9794A-RFSC1 and IC: 5131A-GE910

MonnitLink™ International Cellular Gateway

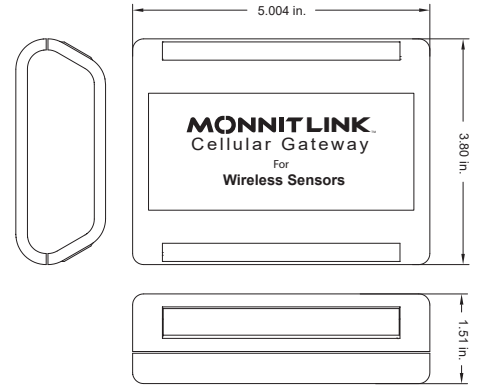

Technical Specifications

Cellular

Cellular Technology	GSM / GPRS Frequency Range: 850 / 900 / 1800 / 1900 MHz
Antenna	Connector: RP-SMA Gain (dBi): 1.5
SIM Card Compatibility	Mini-SIM (2FF) 25 mm x 15 mm x 0.76 mm

Power

Input Power	5.5 VDC @ 2.5 A
Optional Battery Backup	Battery Type: Rechargeable Lithium Polymer
	Battery Duration: Up to 24 hours
	Battery Cycle Life: 500 times

Mechanical

LEDs	Cellular Status LED, Online Status LED, Sensor Network Status LED
Device Memory:	50,000 sensor messages (Sensor messages will be stored in the event of Internet outage and transferred when connection is restored)
Enclosure	ABS
Dimensions	5.004 x 3.8 x 1.51 in.
Weight	7 ounces

Environmental

Operating Temperature	-10 to +45°C (14 to 113°F)
Storage Temperature	-20 to +60°C (-4 to 140°F)
Certifications	FCC: ZTL- RFSC1 and FCC: RI7CE910-DUAL IC: 9794A-RFSC1 and IC: 5131A-CE910DUAL



Notes

Commercial Grade Sensors

Monnit commercial grade sensors are designed for applications in ordinary environments (normal room temperature, humidity and atmospheric pressure). Do not use these sensors under the following conditions as these factors can deteriorate the product characteristics and cause failures and burn-out.

- Corrosive gas or deoxidizing gas - chlorine gas, hydrogen sulfide gas, ammonia gas, sulfuric acid gas, nitric oxides gas, etc.).
- Volatile or flammable gas.
- Dusty conditions.
- Under low or high pressure.
- Wet or excessively humid locations.
- Places with salt water, oils chemical liquids or organic solvents.
- Where there are excessively strong vibrations.
- Other places where similar hazardous conditions exist.

Use these products within the specified temperature range. Higher temperature may cause deterioration of the characteristics or the material quality.

Industrial Grade Sensors - Type 1, 2, 4, 4X, 12 and 13 NEMA Rated Enclosure

Monnit's Industrial sensors are enclosed in reliable, weatherproof NEMA rated enclosures. Our NEMA rated enclosures are constructed for both indoor or outdoor use and protect the sensor circuitry against the ingress of solid foreign objects like dust as well as the damaging effects of water (rain, sleet, snow, splashing water, and hose directed water).

- Safe from falling dirt.
- Protects against wind-blown dust.
- Protects against rain, sleet, snow, splashing water, and hose directed water
- Increased level of corrosion resistance
- Will remain undamaged by ice formation on the enclosure



For more information about our products or to place an order, please contact our sales department at 801-561-5555.

Visit us on the web at www.monnit.com.

Monnit Corporation
3400 South West Temple
South Salt Lake, UT 84115
801-561-5555
www.monnit.com